

01270 760 799

Web Site: www.boatfinderbrokerage.co.uk

E-mail: sales@boatfinderbrokerage.co.uk



**BOATFINDER
BROKERAGE**

Nationwide brokers of quality canal boats

MIDDLEWICH CANAL CENTRE

Kings Lock Boatyard
Booth Lane
Middlewich
Cheshire
CW10 0JJ



REF: 120219

£115,000

- Quality 10/6/5/4mm steelwork with a euro-cruiser style stern with enclosed taff rail and large locker seats. Pram cover to the rear deck.
- Beautifully fitted out by Lifestyle Boat Solutions in light oak to a reverse lay-out.
- Canaline 70hp, 4 cylinder diesel engine with PRM 260 D2 hydraulic gearbox with only 51 hours on the clock. Vetus 95kgf electric bow thruster.

- Stainless steel water tank.
- Spray foam insulation.
- Victron 3kw inverter/charger.
- 4 x roof mounted solar panels.
- S/F stove & diesel fired central heating via under floor heating and radiators.
- Domestic sized appliances including washing machine, tumble dryer, dishwasher and a separate freezer.



BROKER'S SUMMARY

60' x 10' Euro-cruiser Stern Wide Beam. Quality 10/6/5/4mm steelwork with side doors, Euro-cruiser style stern, enclosed taff rail and large locker seats with cushions by Orchard Marine. All weather cruising canopy to the rear deck. Beautifully fitted by Lifestyle Boat Solutions in light oak ply with solid light oak trims to an increasingly popular reverse layout design, the interior benefits from under-floor heating. Powered by a 70hp Canaline, 4 cylinder marine diesel engine with PRM 260 D2 hydraulic gearbox. Vetus 95kgf electric bow thruster.

Four Seasons presents a fantastic opportunity to own a one owner beautifully fitted and well-designed high specification floating apartment. With a wonderfully light and airy interior, this boat must be seen to be fully appreciated. She is fully equipped with every convenience required for a life afloat, including a washing machine, dryer, dishwasher and separate freezer, or would serve as a luxurious holiday home. Viewing is highly recommended.

BSSC to January 2025.

LAYOUT DIAGRAM

(not to scale)

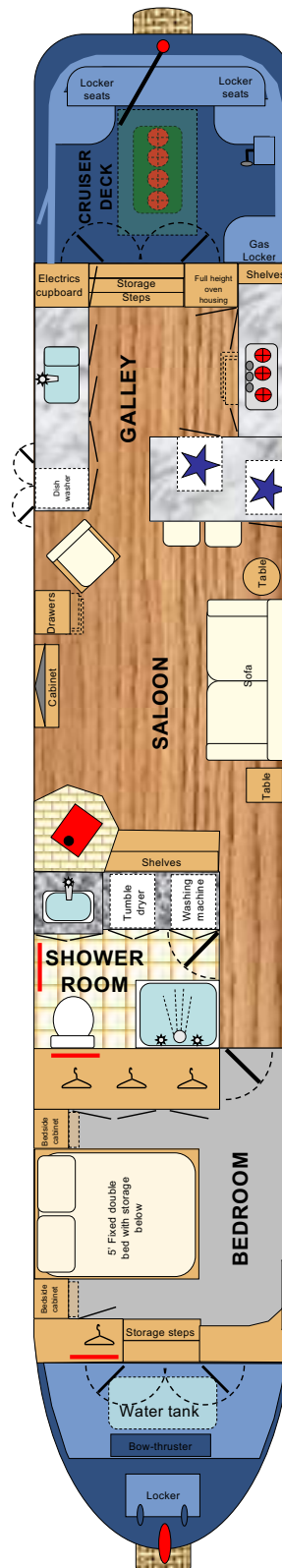



FROM THE BOW

From the bow which has a storage locker there is a 4' open self draining well deck. The stainless steel water tank is located beneath the well deck with a surface mounted filler.

GENERIC FIXTURES AND FITTINGS

The ceilings are white painted T&G (in water resistant MDF). The cabin sides and hull sides are lined with light oak faced plywood with solid light oak trims. All the interior wood has been varnished to a satin finish. Flooring is wood effect laminate to the living areas, tile effect laminate to the shower room and carpet to the bedroom. There are curtains or blinds to all windows.



BEDROOM 11' 2"

Hardwood, 2/3 glazed front doors, open out on to the front deck with storage steps down into the bedroom.

Fixed Furniture: 5' fixed double bed with storage cupboards below. Triple full height wardrobe with mirrored doors. 1 x full height wardrobe with mirrored door. 2 x bedside cabinets. 1 x chest of drawers.

Other Features: JVC, 32" flat screen TV with built in DVD player.

Heating: 2 x central heating radiators.

Lighting: 2 x portholes with top openings. 6 x 12v, ceiling lights. 2 x 12v, LED reading lights.



Power: 6 x 240v sockets (2 with USB ports). 1 x TV satellite point.



SHOWER ROOM 7' 2" x 6' 5"



The cabin shower room a white suite comprising:

Suite: Glazed shower enclosure with glazed sliding doors and a thermostatic waterfall style shower head with separate shower attachment. Large vanity unit with counter top wash basin, chrome mixer tap and a cupboard beneath. Thetford cassette toilet.

Heating: Chrome towel radiator.

Other Features: Illuminated, mirrored bathroom cabinet. Built in utility area housing the Hotpoint washing machine and separate Hotpoint tumble dryer with worktop above.

Lighting: 1 x porthole with top opening and privacy glass. 4 x 12v, LED ceiling lights.



Corridor Lighting: 1 x porthole with top opening. 2 x 12v, LED ceiling lights.



SALOON 16' 10"



Fixed Furniture: Full height display shelves. Bespoke cabinet beneath the TV. Breakfast bar.

Loose Furniture: Leather sofa. Bentwood armchair. Free standing chest of drawers. 2 x occasional tables. 2 x bar stools.

Other Features: Hitachi 40" flat screen TV.

Heating: Morso Squirrel solid fuel stove set on tiled hearth and surround.

Lighting: 4 x windows with top openings. 8 x 12v, ceiling lights.

Power: 6 x 240v sockets. 1 x TV satellite point.





GALLEY 8' 8"

The rear galley has custom built cabinets with white high gloss door and drawer fronts. Solid marble worktops with matching splash-backs.

Base Units: 3 x single cupboards. 2 x large cupboards that extend into the corners. 1 x 3 drawer unit. Full height oven housing with a cupboard below. Fridge housing. Freezer housing. Dishwasher housing. Rear cupboard housing the electrics. Rear storage steps.

Wall Units: 2 x wall mounted shelves. 1 x shelving unit with small drawers.

Appliances: Eye level, Belling gas oven and grill. Stainless steel inset 3 burner gas hob. AEG, 240v fridge. Beko, 240v freezer. Hotpoint slimline dishwasher. Under slung, stainless steel 1 ½ sink with chrome Swans neck monobloc tap.

Power: 6 x 240v sockets.



Lighting: 2 x windows with top openings. 1 x set of steel side doors, wood lined internally. 8 x 12v, ceiling lights.



CRUISER DECK & STERN 7' 10"



Steel rear doors, wood lined internally with sliding roof hatch lead from the galley to the cruiser deck and steering position. The engine is housed under lift up floor panels.



Other Features: Enclosed taff rail and large locker seats with padded seat cushions. Steel gas locker/seat to the port side of the cruiser deck. All weather cruising canopy.

Controls: The column mounted single engine control is on the port side.



SPECIFICATIONS

BUILDER

Quality steelwork by Orchard Marine. Professional fit-out by Lifestyle Boat Solutions.

BUILD DETAILS

Built in 2018
Euro-Cruiser style Wide Beam
10mm/6mm/5mm/4mm

INSULATION

Spray foam insulation behind the cabin linings.

BALLAST

Concrete slabs beneath the floorboards.

DIMENSIONS

Overall Length:	60
Cabin Length:	43' 9"
Width:	10'
Interior Headroom:	6' 10"
Well Deck:	4'
Cruiser Deck	7' 10"
Draught	Not Stated
Air Draught	Not Stated

WINDOWS, DOORS & HATCHES

Port side: 3 x windows with top openings. 2 x portholes with top openings.

Starboard side: 3 x windows with top openings. 1 x set of steel side doors, wood lined internally. 2 x portholes with top openings.

Front: Hardwood, 2/3 glazed front doors.

Rear: Steel rear doors wood lined internally, with sliding roof hatch.

ENGINE & TRANSMISSION

The boat is powered by a 70hp Canaline, 4 cylinder, marine diesel engine coupled to a PRM 260 D2 hydraulic gearbox with 2:1 reduction, turning the propeller. Only 51 hours on the clock. The exhaust is lagged, silenced and vents out from under the side deck. The engine powers twin 12v alternators to charge the start battery and the 3 leisure batteries.

BOW-THRUSTER

Vetus 95kgf electric bow thruster with controls at the stern.

WATER

The 475 litre stainless steel water tank is located beneath the well deck. Water pump with pressure switch is located adjacent to the tank. The twin coil calorifier is heated by the Webasto diesel fired boiler and/or the engine heat exchanger.

HEATING

Heating is provided by the Morso solid fuel stove in the saloon and the Webasto diesel fired boiler running 3 radiators and the under floor heating, plus a Diamond Bidex 30w hot air radiator in the rear steps.

ELECTRICS

240v circuit from landline with RCD.
12v lights throughout protected by fuses.
2 x 12v, 175/50 amp/hr engine driven alternators.
1 x 12v, 110 amp/hr engine start battery.
3 x 12v, 110 amp/hr deep cycle leisure batteries.
Victron 3kw inverter/charger.
4 x roof mounted solar panels.
Battery management system.

GAS

2 x 13kg propane cylinders housed in the stern locker provide gas to the oven, grill and hob.

FIRE SAFETY

3 x 1kg Dry Powder extinguishers
1 x Fire Blanket
1 x Carbon Monoxide Detector
1 x Smoke Alarm

EXTERIOR FINISH

The boat was professionally painted when built. The hull is protected black bitumen and protected by 4 anodes.

ADDITIONAL ITEMS OF INVENTORY

The boat comes equipped with a normal cruising inventory including a full set of ropes and fenders. Any additional items not listed must be negotiated separately with the owner.

MOORING INFORMATION

Moorings are available by separate negotiation.

PLEASE NOTE: The information contained in this brochure is based on our own inspection and information provided by the owner and is intended as a sales aid only to assist you to decide whether you would like to move to the next stage and view the boat for yourself. Measurements can only be taken as approximate. Nothing contained herein constitutes a contract or offer. This is not a survey. We always recommend that a full survey is carried out prior to purchase.